

---

## Index 17352

### Typical Placement of Reflective Pavement Markers

#### **ORIGINATION**

**Date:** 7/13/2017

**Name:** Ed Cashman

**Phone:** (850)414-4314

**Email:** edward.cashman@dot.state.fl.us

#### COMMENTARY

Sheet 1: Changed title to "Typical Placement Of Raised Pavement Markers". Changed labels. Changed Note 1 to "Raised". Deleted Note 5.

Sheet 2: Changed title to "Typical Placement Of Raised Pavement Markers". Changed labels. Deleted blowup detail.

Sheet 3: Added new sheet.

Sheet 4: Added new sheet.

#### **COMMENTS AND RESPONSES**

**BLACK** = Industry Review Comments    **RED** = Standard Plans Response

**Name:** Pete Yauch, P.E.

**Date:** Friday, September 1, 2017 2:19 PM

#### **COMMENT:**

On new sheets 3 and 4, where RPMs are located along the radius of a median nose, the orientation of the markers should be specified – i.e., oriented toward approaching traffic, and not necessarily with the reflective faces perpendicular to the edge line or curb face.

#### **RESPONSE:**

September 13, 2017

Agree, notes have been added to these sheets and details have been revised. Changes made.

---

**Name:** Stephanie Sharp

**Date:** Thursday, September 14, 2017 11:26 AM

#### **COMMENT:**

Sheet 1: Alternating Skip Line detail inconsistent with 17346.

#### **RESPONSE:**

September 13, 2017

Sheet 1: This is consistent. This shows Two-Lane, Two-Way. No change made.

---

## Index 17352

### Typical Placement of Reflective Pavement Markers

**Name:** Karina Fuentes, P.E.

**Date:** Monday, September 25, 2017 5:30 PM

**COMMENT:**

Sheet 2: (See Markup)

- a. Suggest to remove text from Direction of Travel Arrow as it is already included in the legend.
- b. 12" White line in the PLACEMENT OF RPMs ON SHOULDER MARKINGS detail is in conflict with Index 711-003 Sheet 1.

Sheet 4: Show arrow 25' for the gore area in DETAIL "G" as per Index 17346 Sheet 7. (See Markup)

**RESPONSE:**

September 27, 2017

Sheet 2:

- a. Agreed. Change made.
- b. Agreed. Change made.

Sheet 4: Clarified that those symbols are only for illustrative purpose. Change made.

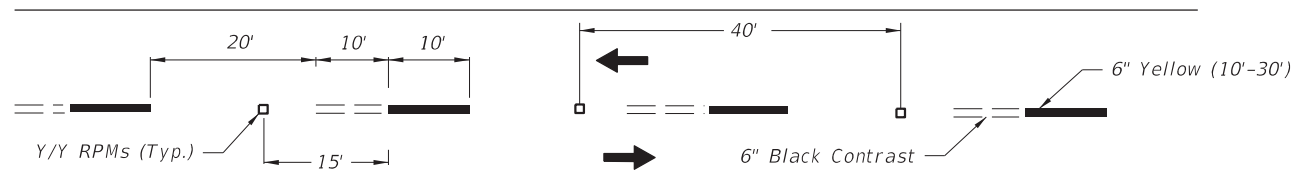

ALTERNATING SKIP LINE

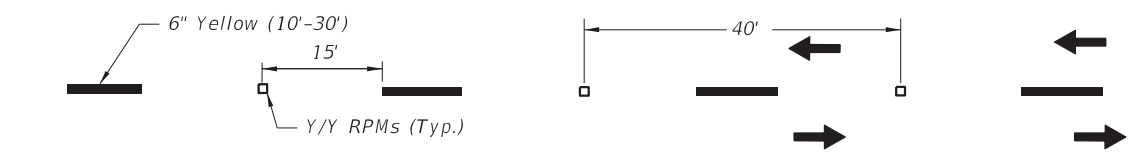

SKIP LINE

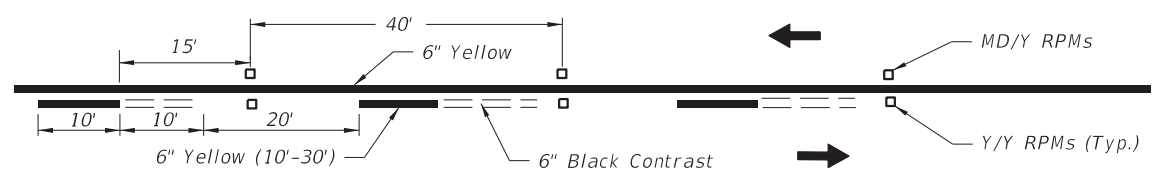

SOLID LINE WITH ALTERNATING SKIP

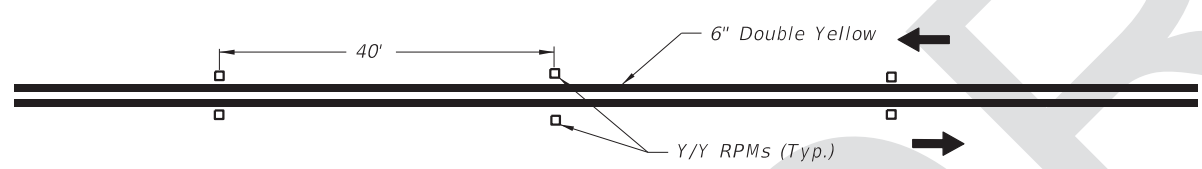

DOUBLE SOLID LINE

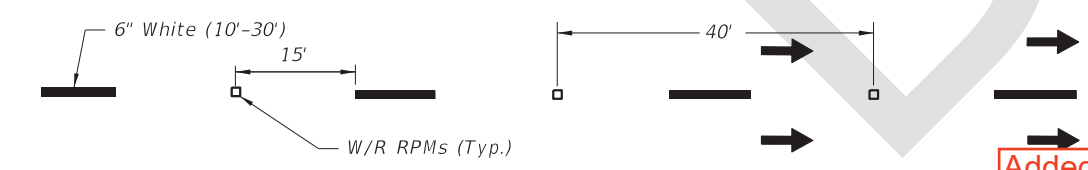

MULTILANE

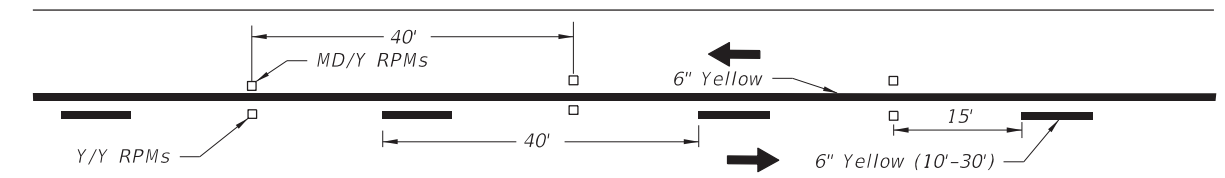

SOLID LINE WITH SKIP

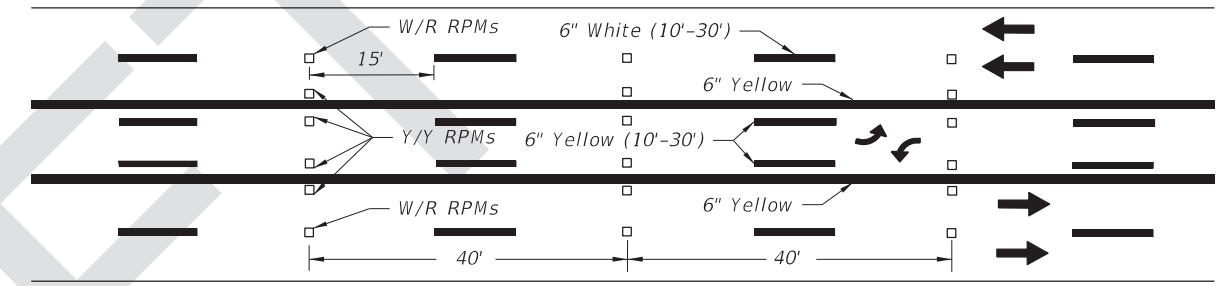

SKIP LINE WITH TWO-WAY LEFT TURN LANE

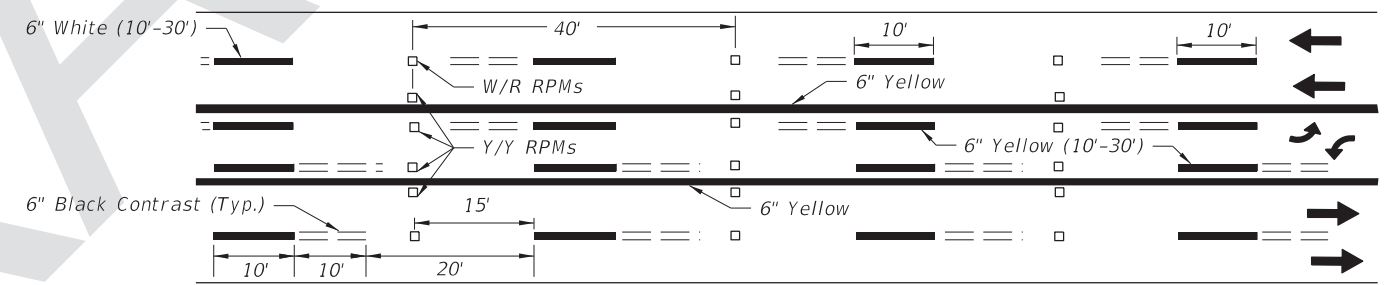

ALTERNATING SKIP LINE WITH TWO-WAY LEFT TURN LANE

**GENERAL NOTES:**

1. All RPMs shall be offset 1" from solid longitudinal lines, unless otherwise noted or shown.
2. Spacing may be reduced for sharp curves if required.
3. For placement of RPMs on ramps, see Index 711-003.

**LEGEND:**

- B/C = BACK OF CURB
- EOP = EDGE OF PAVEMENT
- RPM = RAISED PAVEMENT MARKER
- W/R = WHITE/RED RPM
- Y/Y = YELLOW/YELLOW RPM
- Y/R = YELLOW/RED RPM
- MD/Y = MONO-DIRECTIONAL YELLOW RPM

~~→ = INDICATES DIRECTION OF TRAFFIC FLOW~~

Added Note →

Deleted All and Replaced with Direction of Travel Arrow

8/23/2017 3:37:30 PM

LAST REVISION 11/01/17	REVISION	DESCRIPTION:		FY 2018-19 STANDARD PLANS	<b>TYPICAL PLACEMENT OF RAISED PAVEMENT MARKERS</b>	INDEX 706-001	SHEET 1 of 4
---------------------------	----------	--------------	--	------------------------------	---	------------------	-----------------

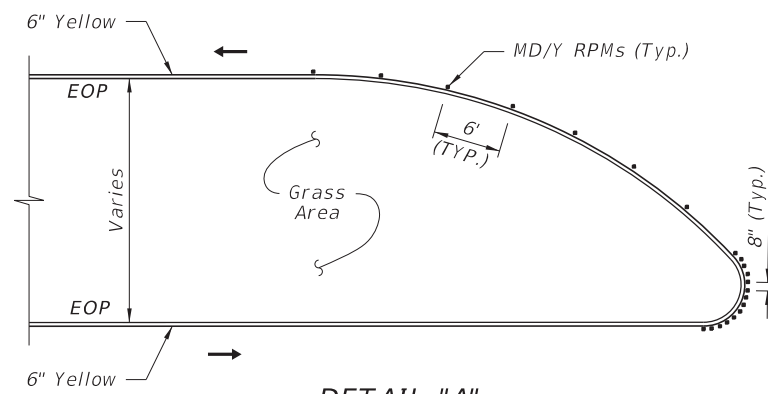

DETAIL "A"

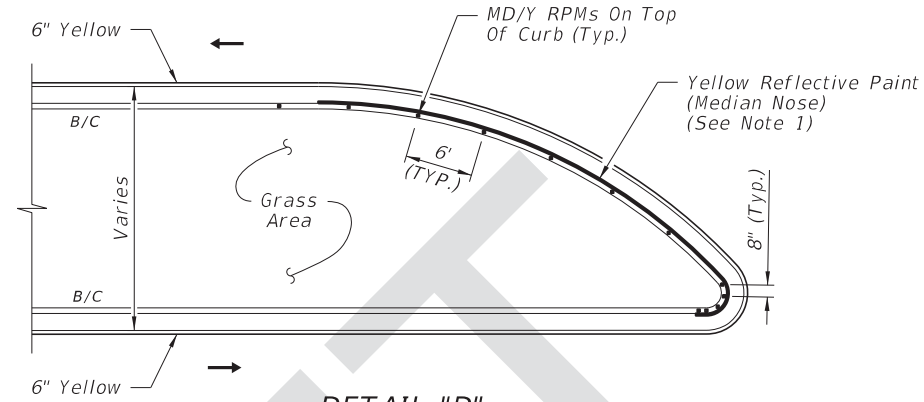

DETAIL "D"

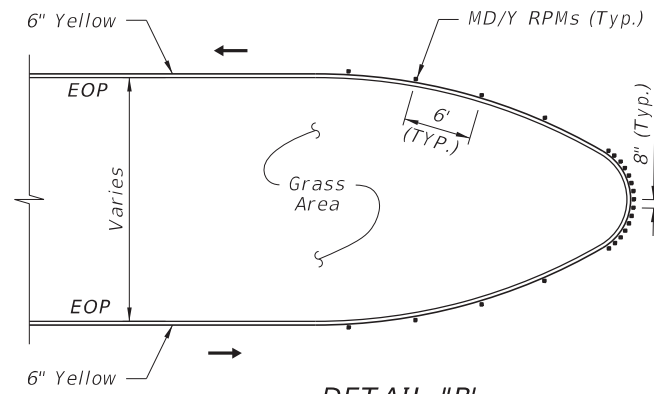

DETAIL "B"

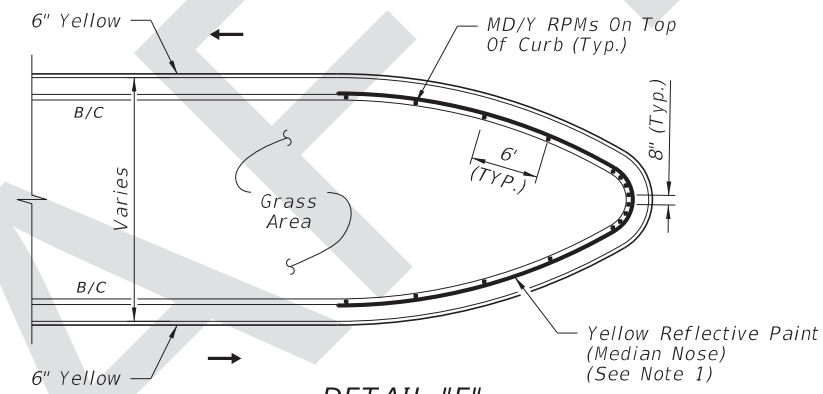

DETAIL "E"

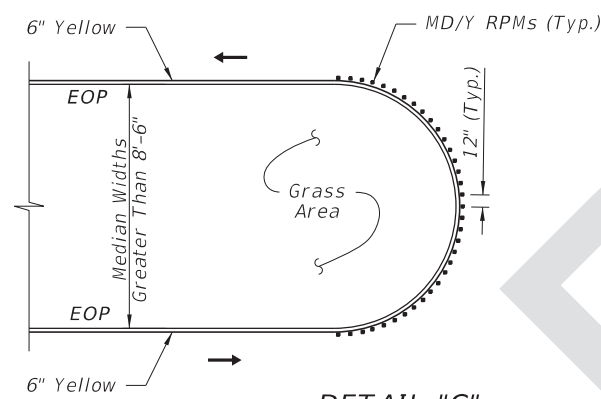

DETAIL "C"

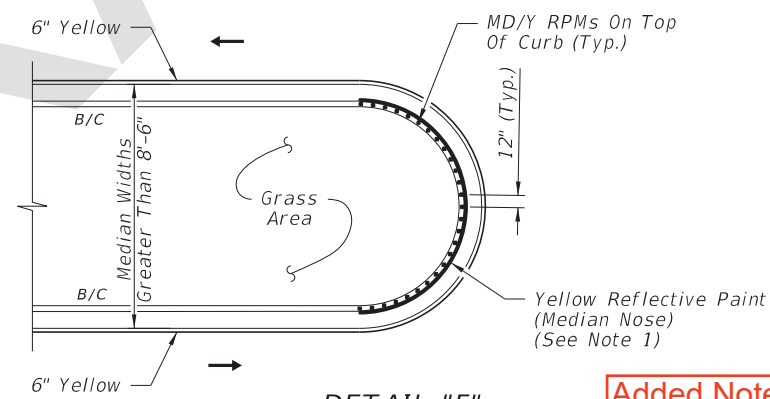

DETAIL "F"

FLUSH MEDIAN OPENINGS

TYPE "D" OR "F" CURB



Added Nose Detail

POSTED SPEED LIMIT MPH	"Y" FEET
30 OR LESS	10
35	20
40	20
45	30
50 OR MORE	40

**LEGEND:**

- B/C = BACK OF CURB
- EOP = EDGE OF PAVEMENT
- RPM = RAISED PAVEMENT MARKER
- W/R = WHITE/RED RPM
- Y/Y = YELLOW/YELLOW RPM
- Y/R = YELLOW/RED RPM
- MD/Y = MONO-DIRECTIONAL YELLOW RPM

INDICATES DIRECTION OF TRAFFIC FLOW

**NOTES:**

1. Furnish and install reflective paint on the face of curb for the limits shown in the above details.
2. For Type "E" Curb, install RPMs along the pavement edge marking using the same spacing shown.

Added Note 3 to clarify RPMs orientation along the radius of the median nose

PLACEMENT OF RPMS AT MEDIAN OPENINGS

8/23/2017 3:37:31 PM

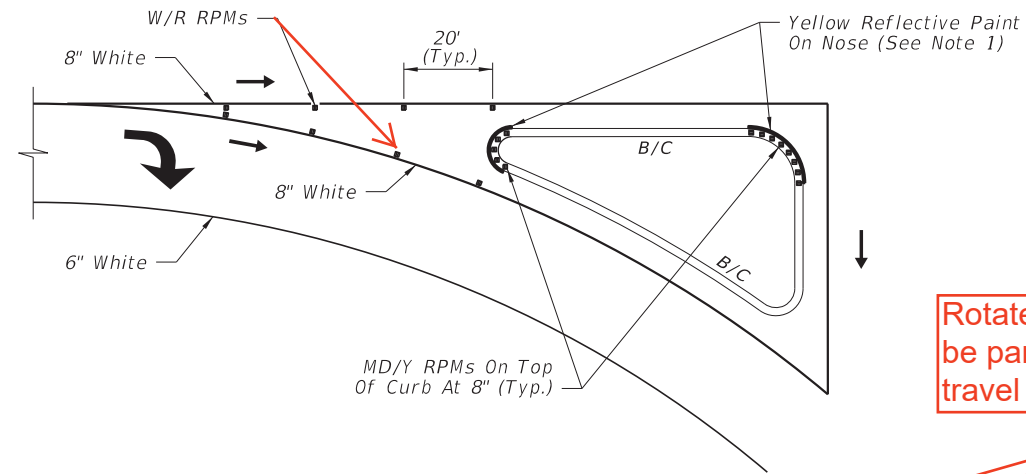

DETAIL "G"

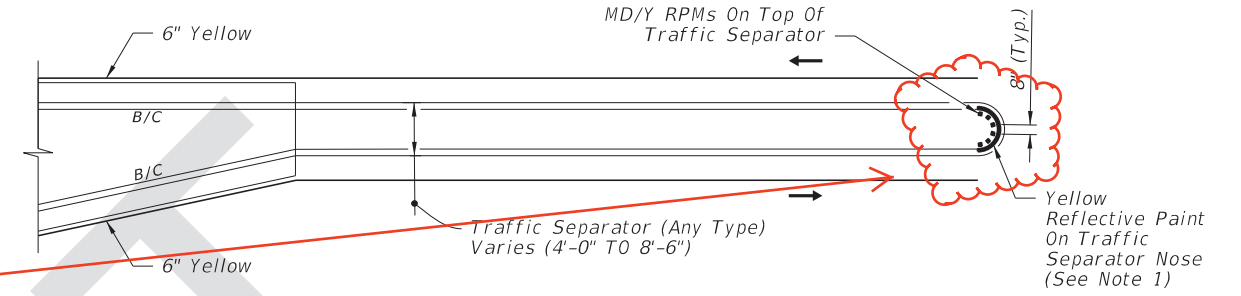

DETAIL "I"

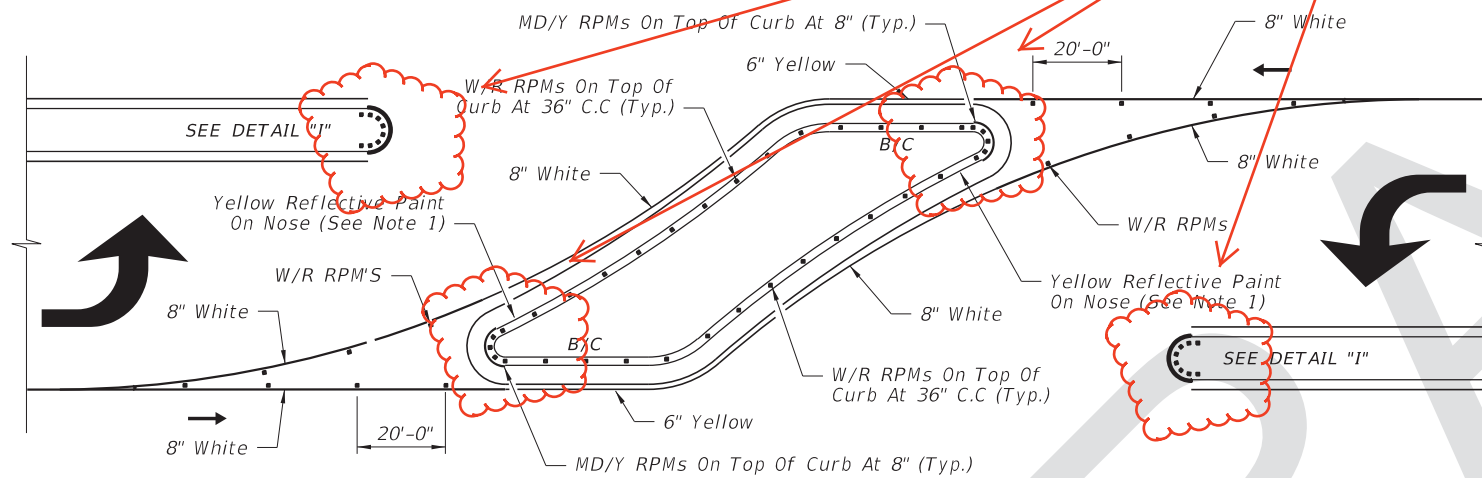

DETAIL "H"

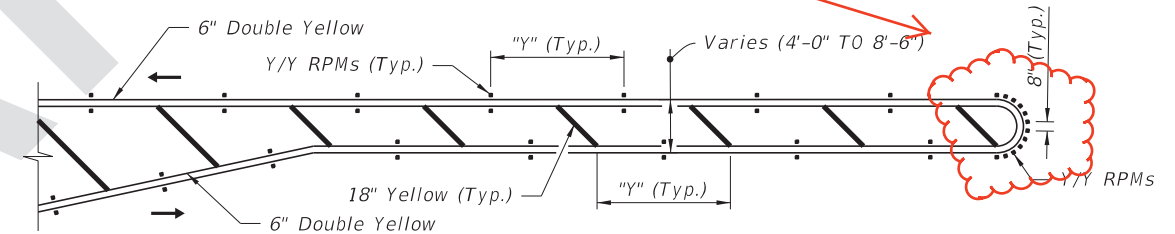

DETAIL "J"

Rotated RPMs to be parallel to the travel lanes

Added Note 3 to clarify RPMs orientation along the radius of the median nose

PLACEMENT OF RPMS AT ISLANDS

PLACEMENT OF RPMS AT TRAFFIC SEPARATORS

POSTED SPEED LIMIT MPH	"Y" FEET
30 OR LESS	10
35	20
40	20
45	30
50 OR MORE	40

NOTES:

1. Furnish and install reflective paint on the face of curb for the limits shown in the above details.
2. For Type "E" Curb install RPMs along the pavement edge marking using the same spacing shown.

LEGEND:

- B/C = BACK OF CURB
- EOP = EDGE OF PAVEMENT
- RPM = RAISED PAVEMENT MARKER
- W/R = WHITE/RED RPM
- Y/Y = YELLOW/YELLOW RPM
- Y/R = YELLOW/RED RPM
- MD/Y = MONO-DIRECTIONAL YELLOW RPM

~~→ = INDICATES DIRECTION OF TRAFFIC FLOW~~

8/23/2017 3:37:31 PM

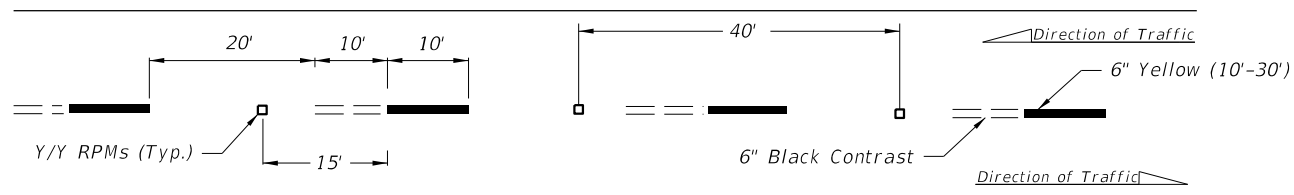

ALTERNATING SKIP LINE

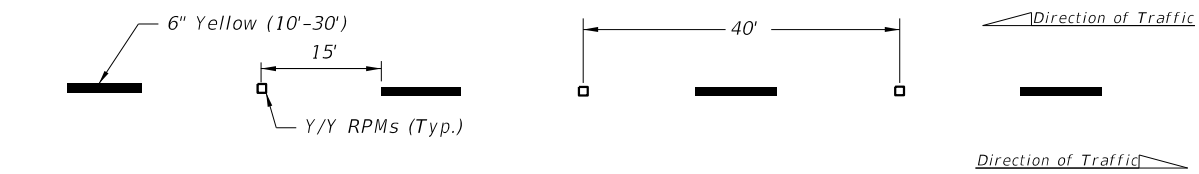

SKIP LINE

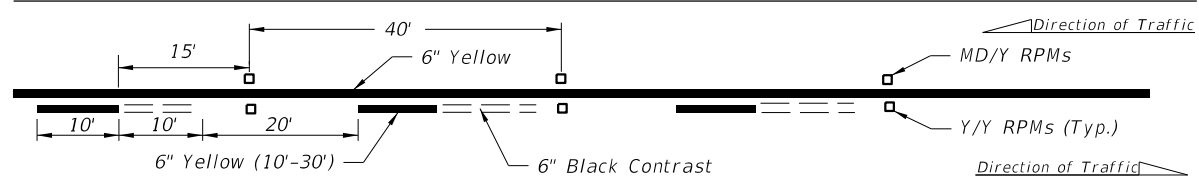

SOLID LINE WITH ALTERNATING SKIP

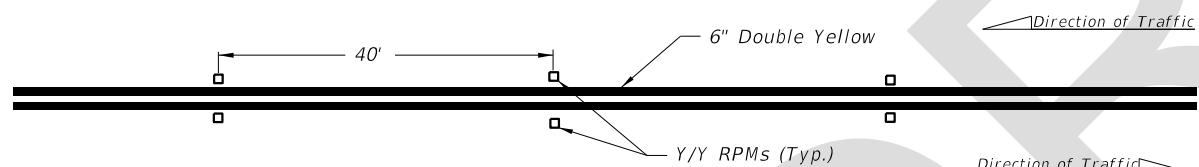

DOUBLE SOLID LINE

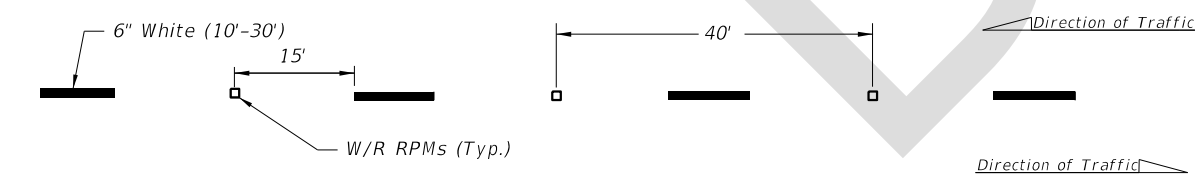

MULTILANE

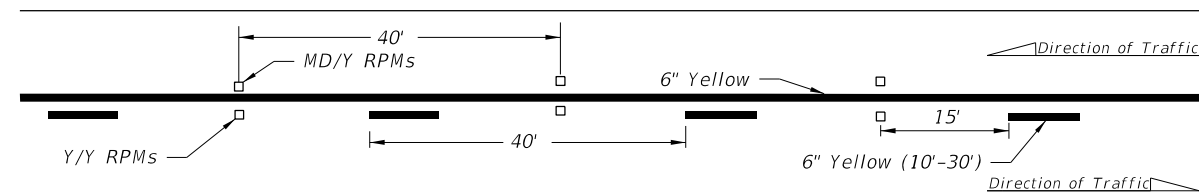

SOLID LINE WITH SKIP

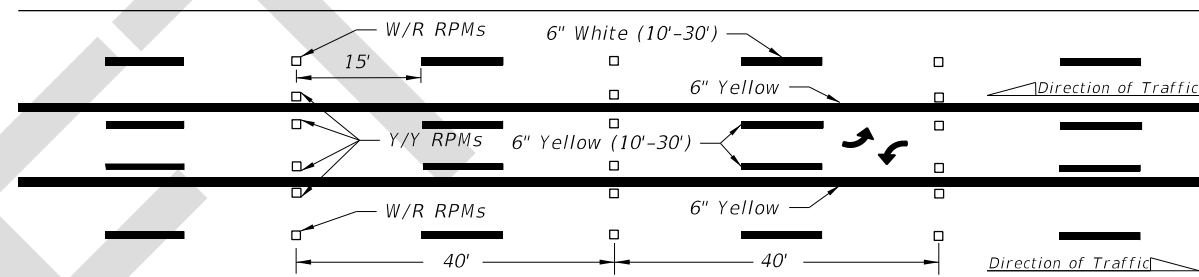

SKIP LINE WITH TWO-WAY LEFT TURN LANE

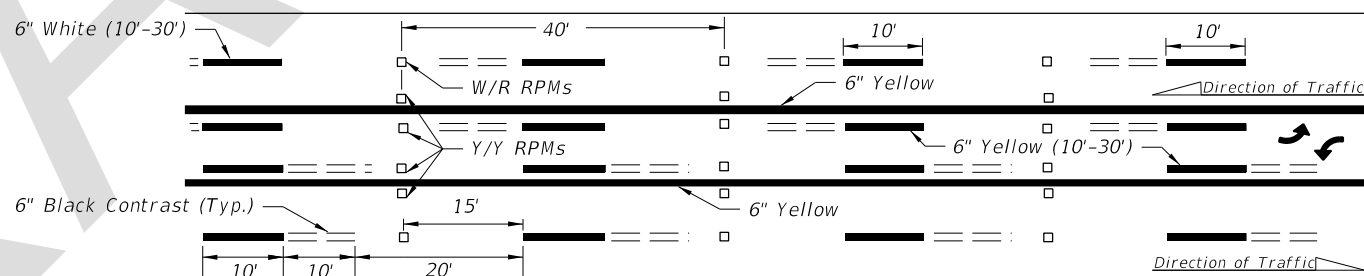

ALTERNATING SKIP LINE WITH TWO-WAY LEFT TURN LANE

**GENERAL NOTES:**

1. Offset all RPMs 1" from solid longitudinal lines unless otherwise noted or shown.
2. Spacing may be reduced for sharp curves if required.
3. For placement of RPMs on ramps, see Index 711-003.
4. Make the traffic face of the RPM the same color as the pavement marking that it is supplementing.

**LEGEND:**

- B/C = BACK OF CURB
- EOP = EDGE OF PAVEMENT
- RPM = RAISED PAVEMENT MARKER
- W/R = WHITE/RED RPM
- Y/Y = YELLOW/YELLOW RPM
- Y/R = YELLOW/RED RPM
- MD/Y = MONO-DIRECTIONAL YELLOW RPM

9/28/2017 9:53:28 AM

LAST REVISION 11/01/17	REVISION	DESCRIPTION:		<b>FY 2018-19 STANDARD PLANS</b>	<b>TYPICAL PLACEMENT OF RAISED PAVEMENT MARKERS</b>	INDEX 706-001	SHEET 1 of 4
---------------------------	----------	--------------	--	--------------------------------------	---	------------------	-----------------

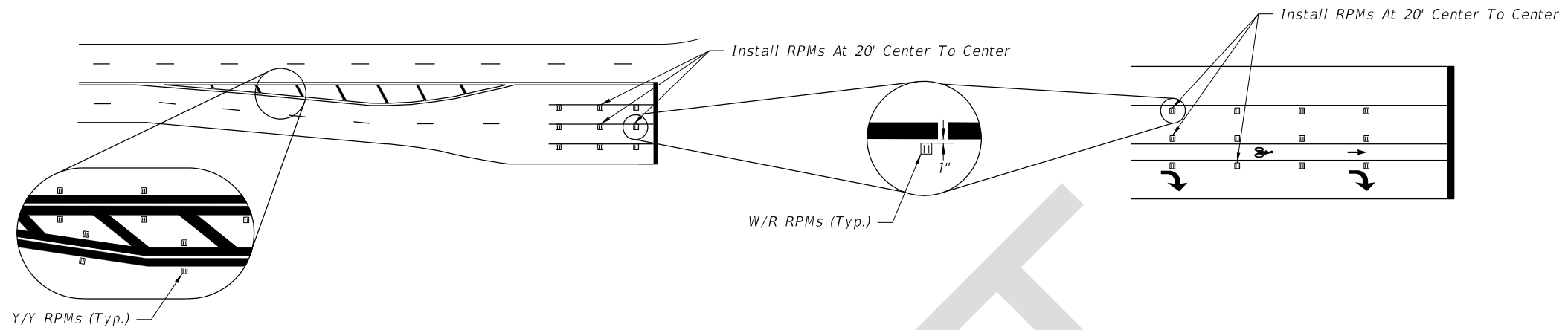

RPM PLACEMENT AT INTERSECTIONS

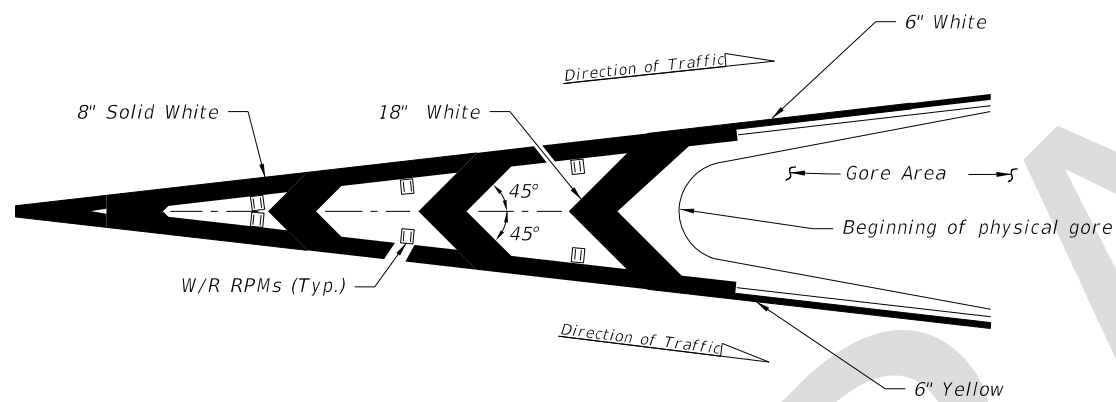

RPM PLACEMENT AT TRAFFIC CHANNELIZATION AT GORE  
(Traffic Flows In Same Direction)

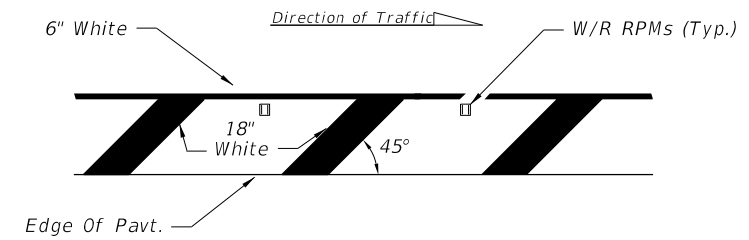

Right side of the roadway shown. For the left side of roadway, the pavement marking is yellow and oriented opposite hand.

RPM PLACEMENT AT ROADSIDE CROSSHATCHING

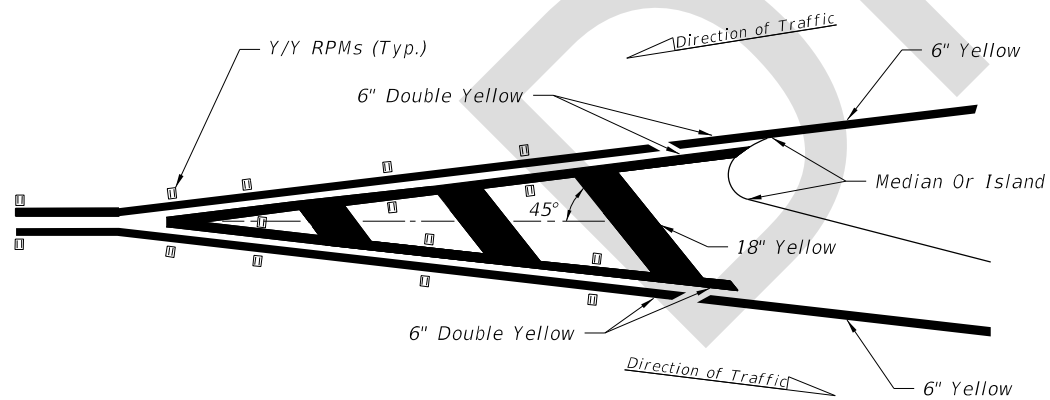

RPM PLACEMENT AT TRAFFIC SEPARATION  
(Traffic Flows In Opposite Direction)

**NOTE:**

1. Center the Raised Pavement Markers between chevrons and crosshatching.

**LEGEND:**

- B/C = BACK OF CURB
- EOP = EDGE OF PAVEMENT
- RPM = RAISED PAVEMENT MARKER
- W/R = WHITE/RED RPM
- Y/Y = YELLOW/YELLOW RPM
- Y/R = YELLOW/RED RPM
- MD/Y = MONO-DIRECTIONAL YELLOW RPM

9/28/2017 9:53:29 AM

LAST REVISION 11/01/17	REVISION	DESCRIPTION:		FY 2018-19 STANDARD PLANS	TYPICAL PLACEMENT OF RAISED PAVEMENT MARKERS	INDEX 706-001	SHEET 2 of 4
---------------------------	----------	--------------	--	------------------------------	---	------------------	-----------------

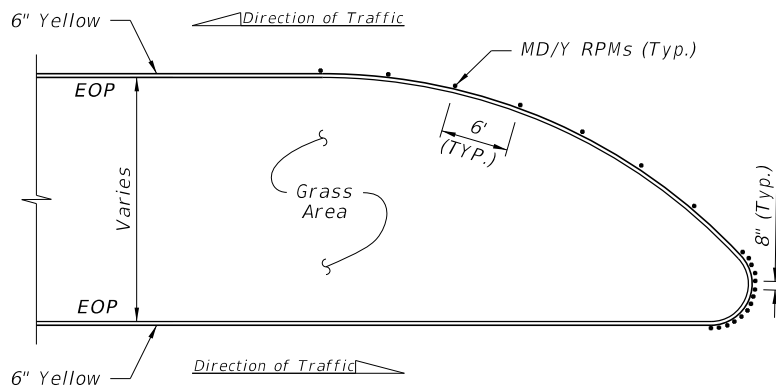

DETAIL "A"

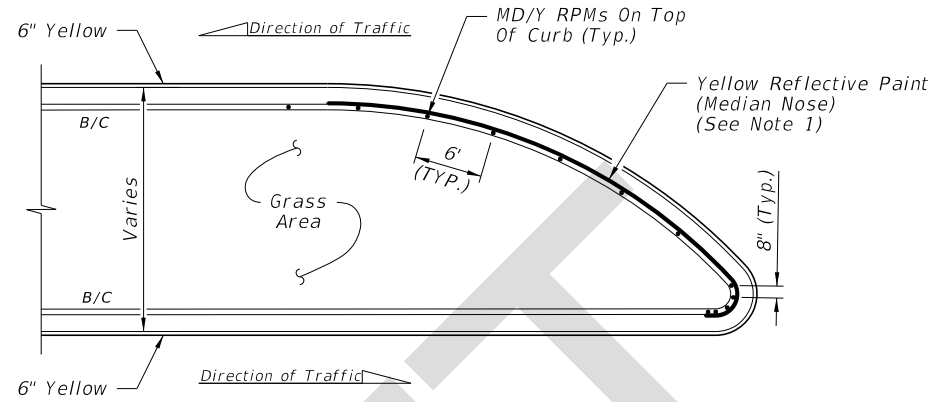

DETAIL "D"

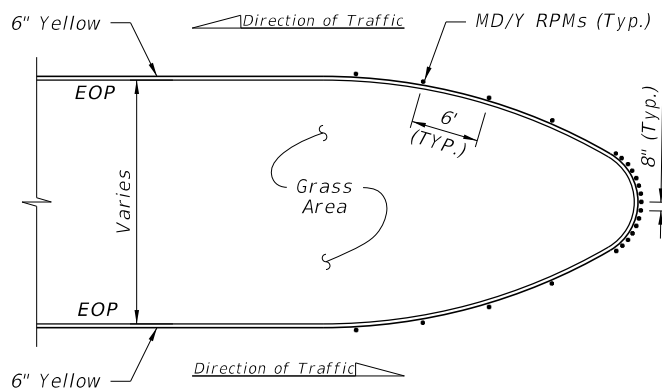
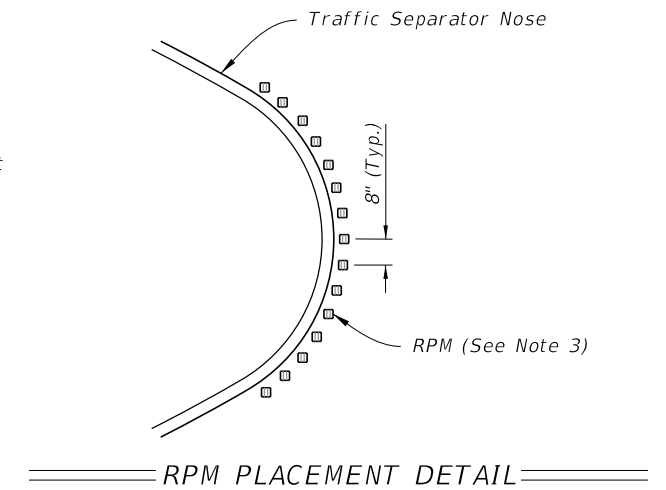

DETAIL "B"

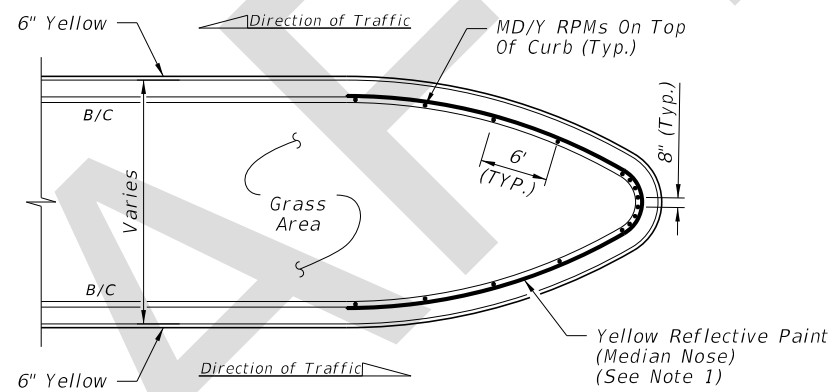

DETAIL "E"

POSTED SPEED LIMIT MPH	"Y" FEET
30 OR LESS	10
35	20
40	20
45	30
50 OR MORE	40

**LEGEND:**

- B/C = BACK OF CURB
- EOP = EDGE OF PAVEMENT
- RPM = RAISED PAVEMENT MARKER
- W/R = WHITE/RED RPM
- Y/Y = YELLOW/YELLOW RPM
- Y/R = YELLOW/RED RPM
- MD/Y = MONO-DIRECTIONAL YELLOW RPM

**NOTES:**

1. Furnish and install reflective paint on the face of curb for the limits shown in the above details.
2. For Type "E" Curb, install RPMs along the pavement edge marking using the same spacing shown.
3. Orient traffic faces of RPMs in curb median radii to be parallel to direction of travel lanes.

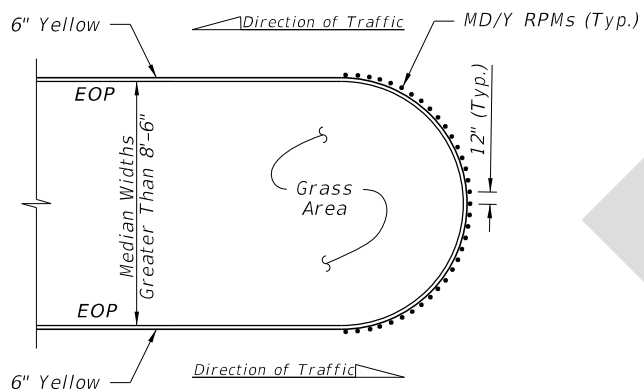

DETAIL "C"

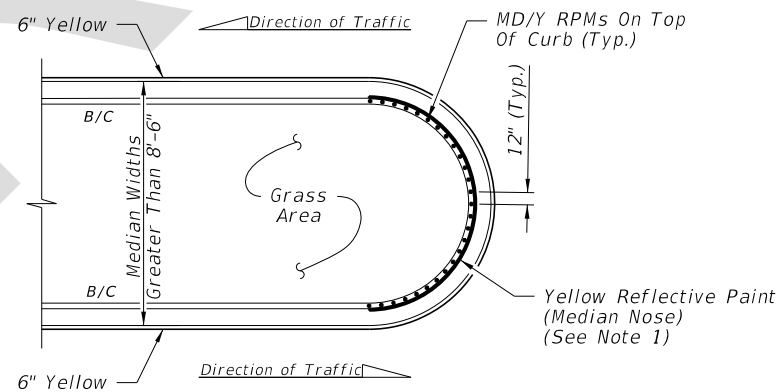

DETAIL "F"

FLUSH MEDIAN OPENINGS

TYPE "D" OR "F" CURB

RPM PLACEMENT AT MEDIAN OPENINGS

9/28/2017 9:53:29 AM



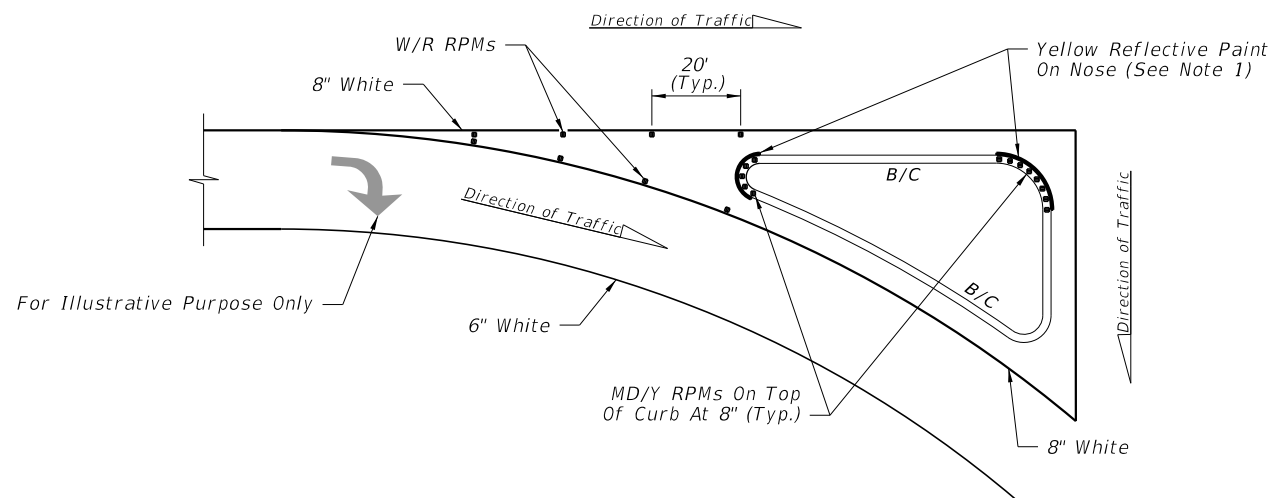

DETAIL "G"

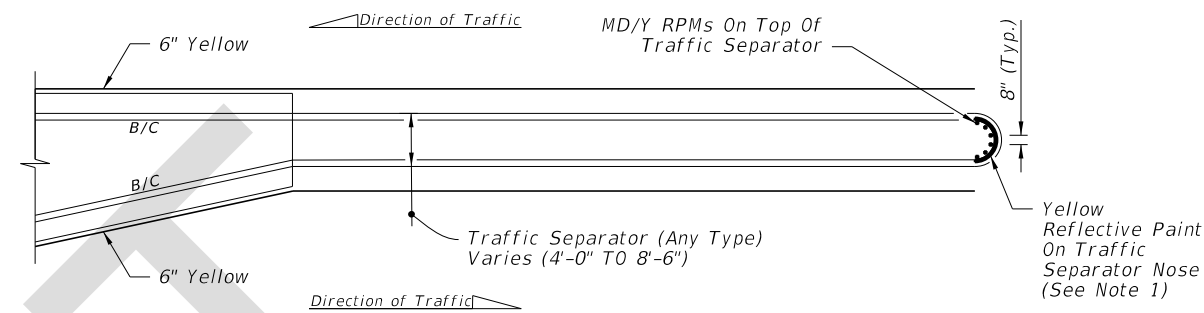

DETAIL "I"

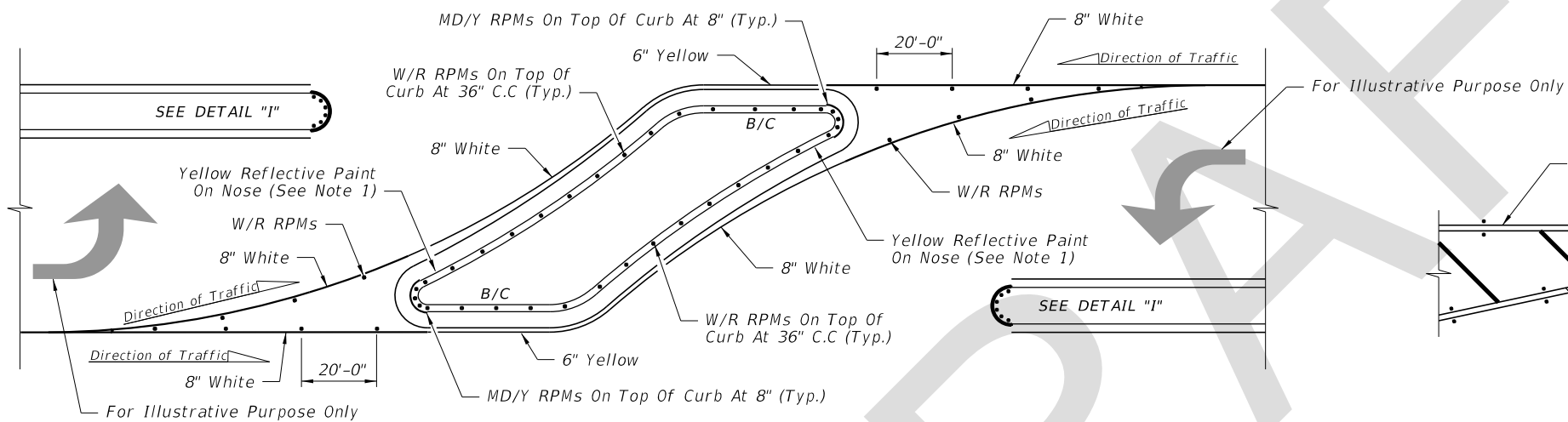

DETAIL "H"

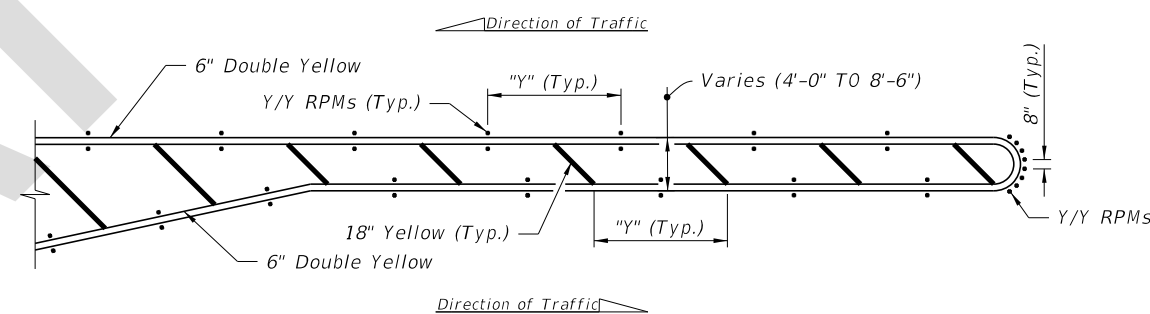

DETAIL "J"

RPM PLACEMENT AT ISLANDS

RPM PLACEMENT AT TRAFFIC SEPARATORS

POSTED SPEED LIMIT MPH	"y" FEET
30 OR LESS	10
35	20
40	20
45	30
50 OR MORE	40

NOTES:

1. Furnish and install reflective paint on the face of curb for the limits shown in the above details.
2. For Type "E" Curb install RPMs along the pavement edge marking using the same spacing shown.
3. Orient traffic faces of RPMs in median radii to be parallel to direction of travel lanes.

LEGEND:

- B/C = BACK OF CURB
- EOP = EDGE OF PAVEMENT
- RPM = RAISED PAVEMENT MARKER
- W/R = WHITE/RED RPM
- Y/Y = YELLOW/YELLOW RPM
- Y/R = YELLOW/RED RPM
- MD/Y = MONO-DIRECTIONAL YELLOW RPM

9/28/2017 9:53:30 AM

LAST REVISION	DESCRIPTION:
11/01/17	



FY 2018-19  
STANDARD PLANS

TYPICAL PLACEMENT OF  
RAISED PAVEMENT MARKERS

INDEX  
706-001

SHEET  
4 of 4